

Lab Autoclaves | Automatic Sterilization, Touch Screen Operation

SJ511C/811C

Operating temp. range 45~138°C

Max. working pressure 0.3MPa

Internal capacity 50L 80L

The steam sterilizer features a 7-inch color touchscreen for simple operation with advanced functions.



Features

- 7-inch large touchscreen, easy operation with options for Chinese, Japanese, and English languages, along with a three-level authorization management system.
- Maximum sterilizing temperature goes up to 138°C, suitable for protein modification.
- By simple setting and operation, these sterilizers manage ordinary sterilization, sterilization of culture mediums and liquids, and dissolution of culture mediums.
- Custom programs can be saved for repeated use.
- Standard equipped with cooling fan to shorten cool down time.
- Equipped with multiple pressure lid opening protection locks and comprehensive safety measures.
- Display power consumption, accumulated power usage, CO₂ emissions, total power-on time, accumulated operating time, and accumulated times of operations.
- Two handles on each side for easy moving.
- Optional automatic water filling function available for purchase.

Specifications

Model	SJ511C	SJ811C	
System	Automatic high-pressure steam sterilization		
Performance	Operating temp. range	45~138°C: 45~80°C (preheat temp.)/45~60°C (retain temp.)/60~110°C (dissolution)/105~138°C (sterilizing)	
	Temp. unit	0.1°C	
	Max. working pressure	0.3MPa	
Lid structure	Manual upward opening and downward closing with an interlock for safety		
Chamber	Material	3mm thick corrosion-resistant stainless steel, featuring a mirror finish surface	
	Design operational life	20 years	
	Design pressure	0.42MPa	
	Design temp.	151°C	
	Heater	110V, 1500W×2	110V, 2000W×2
	Exhaust valve	Solenoid valves: One for full exhaust and one for slow exhaust.	
	Options	Sample sensor interface (1/4), data logger sensor interface (1/4), pressure gauge interface (on solenoid valve piping), automatic water intake (R1/4)	
	Cooling fan blade	Axial fan motor	
Controllers	Temp. control method	PID control by microprocessor	
	Temp. control setting/display method	7-inch color LCD touchscreen for display and settings	
	Timer	1 min~99 h 59 min, resolution: 1 min or 100 h~999 h, resolution: 1 h	
	Operation functions	Instrument sterilization course, liquid sterilization course, sterilization and retain temp. course, dissolution and retain temp. course	
	Other functions	Power consumption, accumulated power usage, CO ₂ emissions, accumulated power-on time, accumulated operating time, and accumulated times of operations, key locking, presetting, saving, preheating, forced cooling, pattern locking, alarm log saving (20 pcs), display of present time, ON-OFF beeping setting, language switch function (Chinese/Japanese/English) and three-level authorization management system, sample sensor (optional)	
Safety device	Sensor failure detection, SSR short-circuit, broken heater wire, prevention of idle heating (water level switch, liquid expansion type), alarm against the absence of drain bottle, failure in locking the lid, memory error detection, pressure relief valve (0.3 MPa)		
Pressure vessel specification	Class I pressure vessel		
Specification	External dimensions (W × D × H mm)	520×660×881	520×660×1161
	Effective dimensions of chamber (diameter×height mm)	370×465	370×745
	Internal effective capacity of chamber	50L	80L
	Weight	Approx. 95kg	Approx. 115kg
	Power supply rated current	AC220V 14A	AC220 19A
Accessories	Basket OSQ-90 (diameter 344 × height 200mm), 2 PCS	Basket OSQ-90H (diameter 344 × height 300mm), 2 PCS	
	1 steam collection cup, 1 cooling water bottle, 1 heater baffle, 1 set of sterilization test cards (30 cards), 1 filter plug, 1m drainage pipe, 1 hose clamp, long-arm clamp (SJ811C model only)		
Options	Biosafety filtration system, sample temperature sensor, internal chamber temperature measurement sensor, miniprinter, data logger, temperature output terminal (4~20mA), external alarm output terminal, time arrival output terminal, standard basket, extended height basket, automatic water filling system		

1 Sterilizers

2 Granulation and Spray Dryers

3 Muffle Furnaces

4 Ovens

5 Incubators

6 Plasma Equipment

7 Water Purification Systems

8 Water Baths

9 Water Circulators

10 Rotary Evaporators

11 Freeze Dryers and Cooling Traps

12 Stirrers & Shakers

13 Washers

14 Analysis and Test Devices

15 Options

Disinfection Certificate

Low bed mode

- Convenient retrieval of sterilized items.

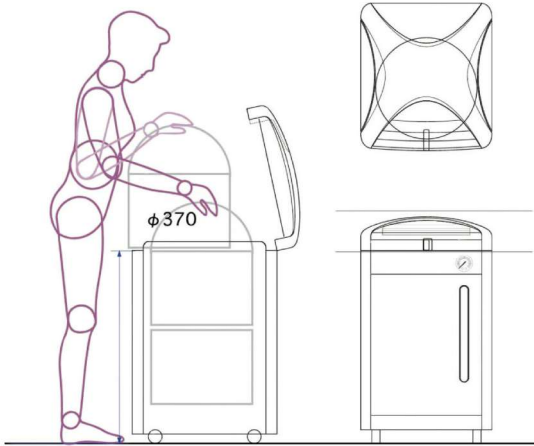

Standard Cooling Fan

- Cooling fan operates after sterilization.
- Cooling down to safe temperature.
- Reducing the time before samples can be taken out.
- Free to choose the forced cooling or natural cooling.

Comparison of cooling time with other devices

(Initial water temperature: 25°C, sterilization temperature: 121°C, ambient temperature: 23°C)

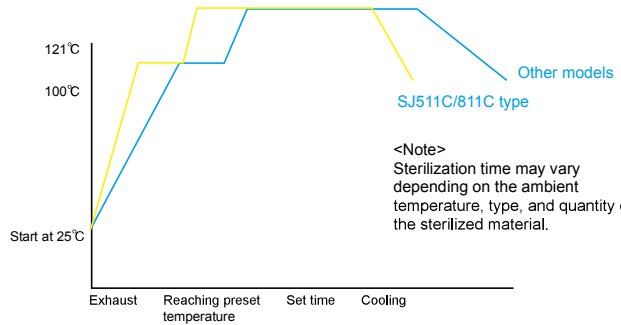

Control panel

- 7-inch color LCD touchscreen with operation



Main screen



Sterilization parameter settings (instrument sterilization program)



Operation mode selection (instrument sterilization program)



Operation mode selection (dissolution and warm keeping program)



Operating status monitoring (instrument sterilization program)

Sterilization starts automatically by sample temperature sensor

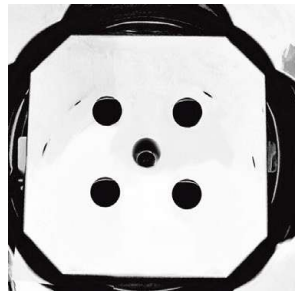

The optional sample temperature sensor controls sterilization time based on the temperature of the sterilized material, ensuring effective sterilization.

Comply with GLP/GMP inspection requirements



Standard equipped with 2 sensor ports on the main unit.



SJ511C/811C is optionally available data logger or built-in micro printer.

Safety valve located on the side



Convenient disassembly for safety valve replacement or calibration.

Sterilizers	1
Granulation and Spray Dryers	2
Muffle Furnaces	3
Ovens	4
Incubators	5
Plasma Equipment	6
Water Purification Systems	7
Water Baths	8
Water Circulators	9
Rotary Evaporators	10
Freeze Dryers and Cooling Traps	11
Stirrers & Shakers	12
Washers	13
Analysis and Test Devices	14
Options	15